





PROPERTY
BUREAU
LETTING & ESTATE AGENTS



Ayr Drive
Airdrie
ML6 9XG

2 
1 
1 

Offers Over £150,000

A really impressive and beautifully maintained 2 bedroom Semi Detached Villa which is situated within a fantastic position on a larger corner plot. Internally the property is in walk in condition and also benefits from a cleverly created low maintenance private garden and a driveway at the rear

The house itself is traditionally constructed and has a render exterior with facing brick and panelled details beneath a pitched concrete tile roof with pvc eaves and fascias.

At the front of the property is a large well maintained lawn with freshly cleaned slabbed pathway leading to the front door with neat and stocked chipstone borders.

At the rear, enclosed by timber fencing, is a lovely private garden area which consists of a neat decked area accessed via sliding patio doors from the dining area and adjacent to this is a good size lawn area which has been laid with Astroturf for low maintenance. This area also then continues on the same level onto a further deck which is ideal for garden and patio furniture.

At the back of this is a further slabbed area with large wooden storage shed. Beyond the back garden is a driveway which affords parking for two cars.



Home Report Valuation
£160,000



The house itself is very well presented and in excellent condition throughout with a modern bright interior, great size rooms including dual aspects from both the lounge and the main upstairs bedroom.

The accommodation comprises front door opening onto entrance vestibule with door through to the main lounge/ living room, which has a window at the front and side and the open staircase leading to the upper level.

The kitchen is well finished with a vast range of floor and wall storage units with light coloured finish and chrome handles. Ample worktop surface area in an L-shaped arrangement including integrated hob oven and hood, integrated fridge freezer and washing machine. At the far side of this room is ample space for a breakfast/dining table and from here patio doors open onto the garden.



On the upper floor there are two bedrooms, the main of which has windows to both the front and side and full width built in wardrobes with sliding mirror doors. The second bedroom has a window overlooking the rear garden and this room also has a really deep walk-in storage cupboard which also houses the boiler.



The bathroom is tiled and features a lovely white modern suite comprising panelled bath wash hand basin and WC. Wall mounted electric shower and glass screen. Window to the side.

The property further benefits from Gas central heating. double glazing and a good size loft area.

Vendor Comments

This is such a nice development with great neighbours. So handy for all aemnties and also very easy access to motorway network.

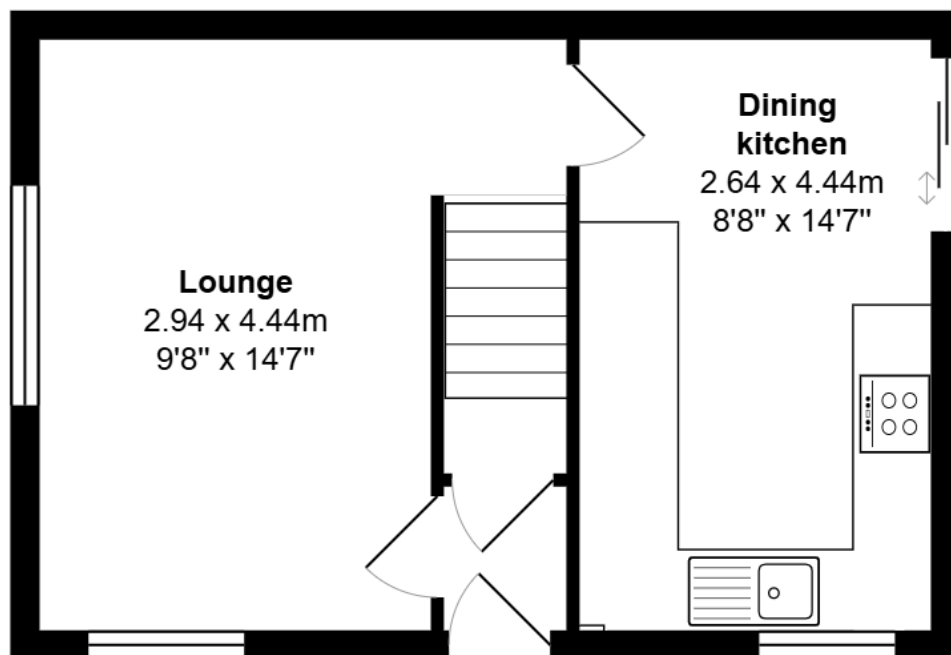
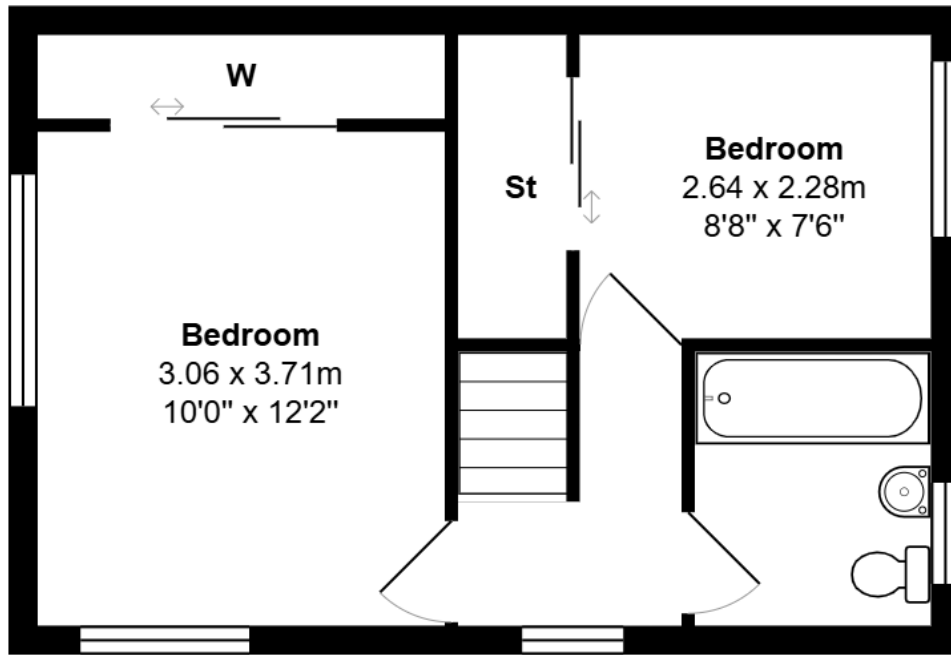

Total Area: 59.6 m² ... 641 ft²

All measurements are approximate and for display purposes only

Location

Airdrie is a well-connected town in North Lanarkshire, ideal for commuters with frequent train services and easy access to the M8 motorway for travel to Glasgow and Edinburgh. The town offers a range of local amenities, including shops, cafes, and supermarkets, along with well-regarded schools, making it perfect for families. For leisure, Airdrie has sports centres and is near green spaces like Strathclyde and Drumpellier Country Parks.





www.propertybureau.co.uk

Glasgow Stirling Helensburgh **Lanarkshire**

13 Broomknoll Street, Lanarkshire, ML6 6BN

enquiries@propertybureau.co.uk
01236 758111

Whilst this brochure has been prepared with care, it is not a report on the condition of the property. Its terms are not warranted and do not constitute an offer to sell. All area and room measurements are approximate only. Floorplans may not be to scale.

