



Alexander Street
Airdrie
ML6 0BD

2 
1 
1 

Offers Over £105,000

An impressive traditional upper flat with open outlook and attractive communal gardens.

The convenient location combined with the wonderful period feel make this a great addition to the current sales market.



Home Report Valuation
£110,000

Council Tax Band C

EPC Rating D



A spacious upper flat, large expansive windows and open aspects give the perfect ingredients for a bright and airy period property.

The attractive blonde sandstone flat sits on an elevated position and consists of entrance hallway, WC, kitchen with an array of wall and floor units, bright bathroom, two bedrooms and spacious lounge with fabulous bay window.

The flat retains elements of original features with high ceilings, cornice work and deep set skirting boards. All rooms are decorated in bright fresh decor. Warmth is provided by gas fired central heating and double glazing has been installed.



A hidden bonus to the flat is an extensive floored loft which offers huge storage options and has lighting installed.

To the rear of the flat are well tended communal gardens with drying green and seating areas.



Vendor Comments

The spacious flat, convenient location and great neighbours make this a wonderful place to live.

96c, Alexander Street, Airdrie, ML6 0BD

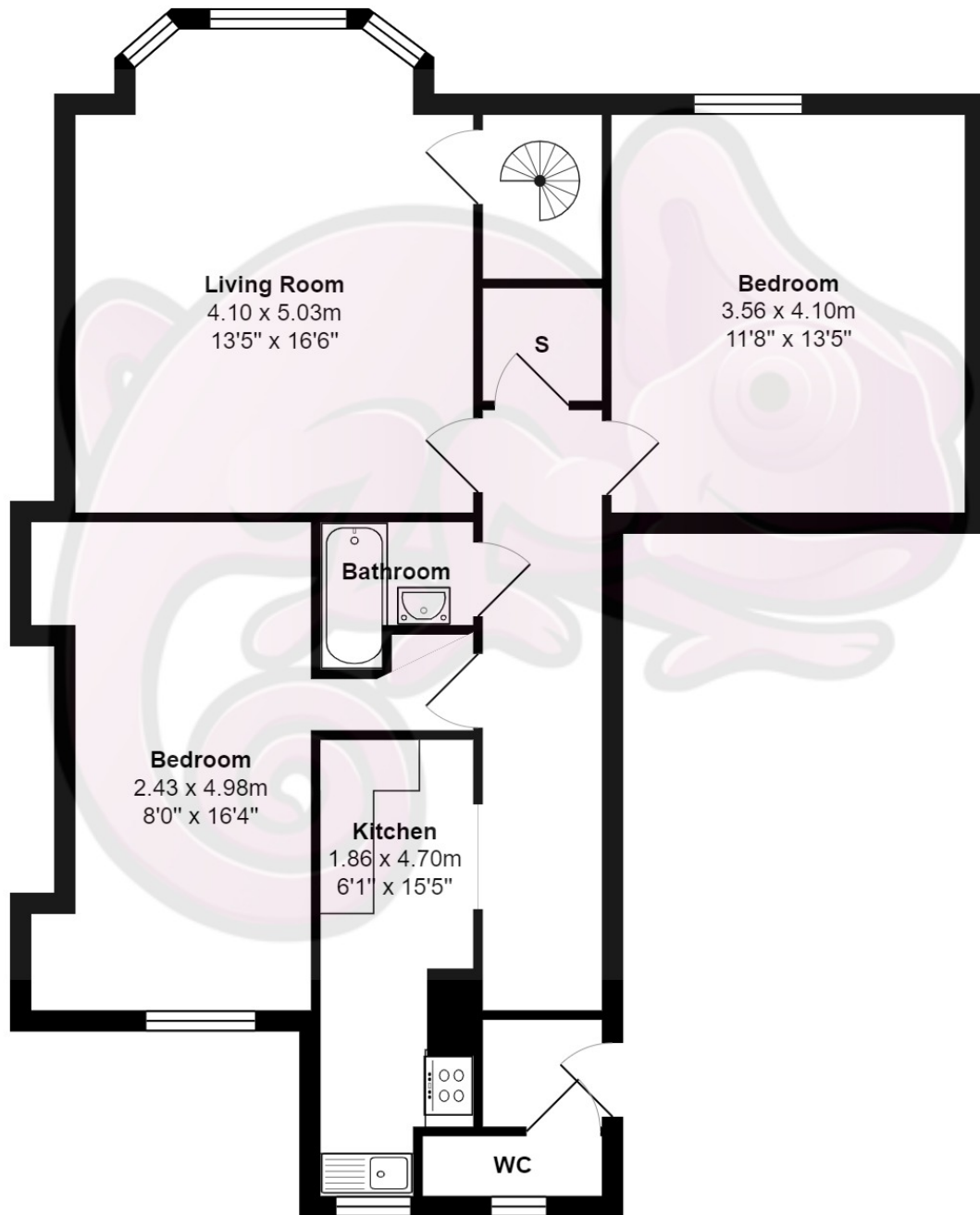

All measurements are approximate and for display purposes only

Location

There are a number of primary schools, high schools, and nurseries on your doorstep along with various supermarkets and other shops and restaurants. Airdrie train station gives you excellent access straight to Glasgow and Edinburgh. Other transport links including the M8 & A8 provide easy access to Glasgow, Edinburgh, Stirling and surrounding neighbouring towns across Lanarkshire.





www.propertybureau.co.uk

Glasgow Stirling Helensburgh **Lanarkshire**

13 Broomknoll Street, Lanarkshire, ML6 6BN

**enquiries@propertybureau.co.uk
01236 758111**

Whilst this brochure has been prepared with care, it is not a report on the condition of the property. Its terms are not warranted and do not constitute an offer to sell. All area and room measurements are approximate only. Floorplans may not be to scale.

