



Moran Court  
Wishaw  
ML2 8FB

2   
1   
2 

## Offers Over £114,995

Property Bureau Airdrie are delighted to offer to the marketplace this extremely spacious ground floor 2-bedroom apartment with further accommodation to include. A spacious hallway with fitted cupboards, dining kitchen, lounge, master en-suite and bathroom. The property further benefits from private allocated parking, communal gardens with out building and communal well-kept stairway. The property benefits from gas central heating and double glazing throughout.



Home Report Valuation  
£120,000

packdetails.com  
Ref: HP760374

Postcode: ML2 8FB

Council Tax Band

EPC Rating C



Vendor Comments

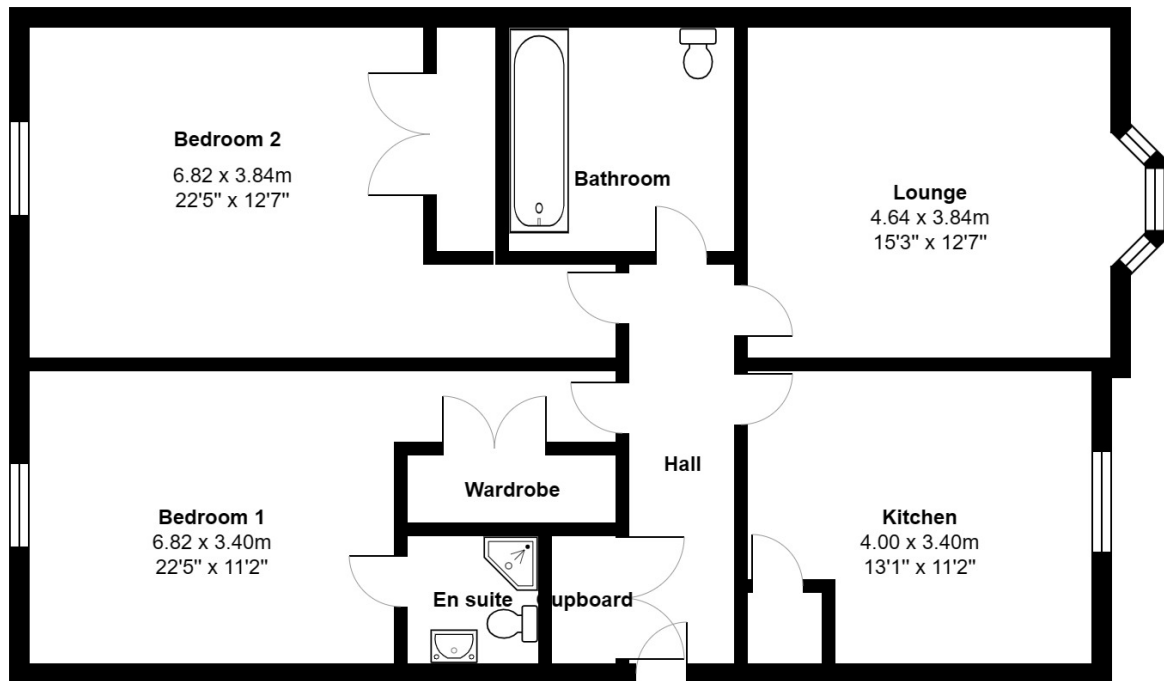

## Location

The property is located within the heart of Wishaw town centre close to all the public and civil amenities that the town has to offer with the health centre at Kenilworth Avenue but a short stroll away. The train station is a 5-minute walk away which offers a regular service between Glasgow and Lanark. An express bus service to Glasgow Buchanan Street is located around the corner on Main Street.





[www.propertybureau.co.uk](http://www.propertybureau.co.uk)

Glasgow   Stirling   Helensburgh   **Lanarkshire**

**13 Broomknoll Street, Lanarkshire, ML6 6BN**

**enquiries@propertybureau.co.uk**  
**01236 758111**

Whilst this brochure has been prepared with care, it is not a report on the condition of the property. Its terms are not warranted and do not constitute an offer to sell. All area and room measurements are approximate only. Floorplans may not be to scale.

