



Gateside Crescent
Airdrie
ML6 6NH

2 
1 
1 

Offers Over £95,000

Property Bureau are delighted to bring to the market this mid terrace property located in the town centre of Airdrie.

The mid terraced property requires upgrading and has great potential.



Home Report Valuation
£98,000



The lower level comprises spacious lounge leading to good sized kitchen and access to the rear private garden.

Stairs to upper level provides access to two double bedrooms, master with built in storage and bathroom with WC, basin and walk in shower.

The property further benefits from gas central heating and double glazing, gardens to the front and private gardens to the rear.



Vendor Comments

Excellent location within walking distance to town centre, yet lovely and quiet

12, Gateside Crescent, Airdrie, ML6 6NH

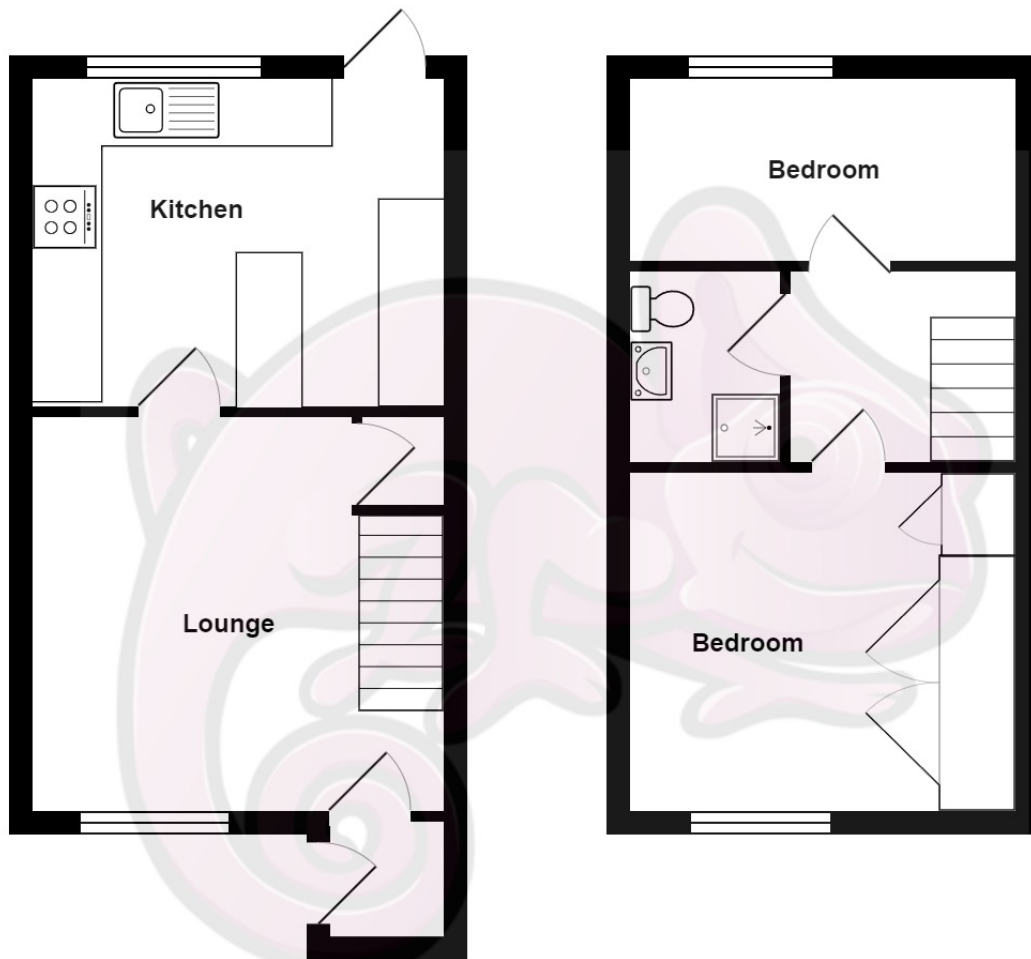

All measurements are approximate and for display purposes only

Location

The property is within walking distance to Airdrie town centre with its selection of bars, restaurants and shops. Airdrie Train station is also within walking distance which allows direct access both east and west to Edinburgh & Glasgow. The property also benefits from its close proximity to the M8 Motorway and its fantastic travel links again east, west and throughout the central belt.





www.propertybureau.co.uk

Glasgow Stirling Helensburgh **Lanarkshire**

13 Broomknoll Street, Lanarkshire, ML6 6BN

**enquiries@propertybureau.co.uk
01236 758111**

Whilst this brochure has been prepared with care, it is not a report on the condition of the property. Its terms are not warranted and do not constitute an offer to sell. All area and room measurements are approximate only. Floorplans may not be to scale.

